

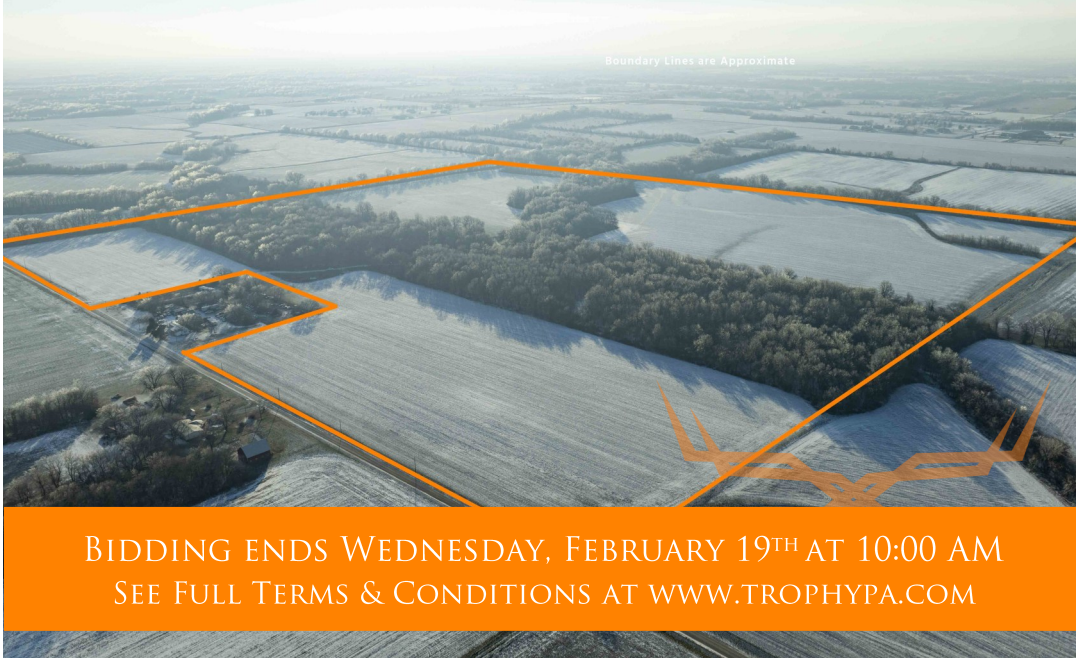

**T R O P H Y**  
PROPERTIES AND AUCTION  
LAND | RECREATIONAL | RESIDENTIAL

# Barton County Missouri Land for Sale at Auction - Todd Farm

[www.TrophyPA.com](http://www.TrophyPA.com) • (855) 573-5263 • [leads@trophy.com](mailto:leads@trophy.com)



**BIDDING ENDS WEDNESDAY, FEBRUARY 19<sup>TH</sup> AT 10:00 AM**  
**SEE FULL TERMS & CONDITIONS AT [WWW.TROPHYPA.COM](http://WWW.TROPHYPA.COM)**



**PROPERTY ADDRESS:**  
00 NE 10th Road  
Lamar, MO 64759

**ACRES:** 156±  
**COUNTY:** Barton

## **AUCTION DETAILS:**

**Preview Day Saturday, February 1st 10AM to Noon.**

These 156± flat to gently rolling acres are conveniently located northeast of Lamar near the city limits. The Farm Service Agency figures there to be 105± acres of cropland. This highly productive farm consists mostly of Parsons and Barden silt loams. The remaining 51± acres consists of mature hardwoods and offers excellent hunting and recreation opportunities. The Todd farm would be a nice addition to any farm operation or investment portfolio and lots of possibilities for development in the future with its location to Lamar.



## **PRESENTED BY:**

**CODY CUTLER**  
**Land Specialist**

M: (620) 224-6003  
P: (855) 573-5263 x756  
E: [ccutler@trophy.com](mailto:ccutler@trophy.com)

**Trophy Properties and Auction**  
640 Cepi Drive  
Suite 100  
Chesterfield, MO 63005

[www.TrophyPA.com](http://www.TrophyPA.com)  
[leads@trophy.com](mailto:leads@trophy.com)



**T R O P H Y**  
PROPERTIES AND AUCTION  
LAND | RECREATIONAL | RESIDENTIAL

# Barton County Missouri Land for Sale at Auction - Todd Farm

[www.TrophyPA.com](http://www.TrophyPA.com) • (855) 573-5263 • [leads@trophyapa.com](mailto:leads@trophyapa.com)



The information is believed to be accurate; however, no liability for its accuracy, errors or omissions is assumed. All lines are drawn on maps, photographs, etc. are approximate. Buyers should verify the information to their satisfaction. There are no expressed or implied warranties pertaining to this property. Both real estate (including all improvements, if any) is being sold As Is, Where Is with NO warranties expressed or implied. Please make all inspections and have financing arranged prior to the end of bidding.