

TRACT 2 DESCRIPTION:
A tract of land being the Southeast Quarter of the Southeast Quarter of Section 36, Township 47 North, Range 16 West of the fifth principal meridian, Cooper County, Missouri and being more particularly described as follows:
Beginning at the Southeast corner of said Section 36, thence along the South line of said Section 36, North 86 degrees 17 minutes 26 seconds West, a distance of 1314.23 feet to an iron rod marking the Southwest corner of the Southeast Quarter of the Southeast Quarter of said Section 36; thence North 01 degrees 39 minutes 13 seconds East, a distance of 1340.40 feet to a stone marking the Northwest corner of the Southeast Quarter of the Southeast Quarter of said Section 36; thence South 85 degrees 49 minutes 48 seconds East, a distance of 1315.21 feet to a stone marking the Northeast corner of the Southeast Quarter of the Southeast Quarter of said Section 36; thence South 01 degrees 40 minutes 39 seconds West, a distance of 1329.80 feet to the POINT OF BEGINNING, containing 40.3 acres. Subject to that portion currently being used for public roadway.

TRACT 3 DESCRIPTION:
A tract of land lying in the South half of Section 36, Township 47 North, Range 16 West and part of the Northeast Quarter of the Northwest Quarter of Section 1, Township 46 North, Range 16 West of the fifth principal meridian, Cooper County, Missouri and being more particularly described as follows:
Commencing at the Southeast corner of said Section 36, thence along the South line of said Section 36, North 86 degrees 17 minutes 26 seconds West, a distance of 1314.23 feet to an iron rod marking the Southeast corner of the Southwest Quarter of the Southeast Quarter of said Section 36 and the POINT OF BEGINNING; thence continuing along the South line of said Section 36, North 86 degrees 17 minutes 26 seconds West, a distance of 1314.23 feet to an iron rod marking the Northeast corner of the Northwest Quarter of said Section 1; thence along the East line of said Northwest Quarter, South 00 degrees 41 minutes 46 seconds West, a distance of 40.49 feet to the centerline of Prairie Road; thence along the centerline of Prairie Road the following Three courses, South 71 degrees 18 minutes 53 seconds West, a distance of 323.93 feet to an iron rod; thence, South 69 degrees 35 minutes 54 seconds West, a distance of 268.91 feet to an iron rod; thence South 52 degrees 37 minutes 24 seconds West, a distance of 253.67 feet to a plus cut on the concrete bridge deck; thence along the centerline of Pisgah Creek the following Two courses, North 18 degrees 00 minutes 17 seconds West, a distance of 311.99 feet; thence North 07 degrees 21 minutes 44 seconds West, a distance of 153.41 feet to a point on the South line of said Section 36 being 30.00 feet South 86 degrees 17 minutes 26 seconds East of an iron rod; thence along the South line of said Section 36, North 86 degrees 17 minutes 26 seconds West, a distance of 453.73 feet to an iron rod marking the Southwest corner of the East Half of the Southwest Quarter of said Section 36; thence along the West line of said East Half, North 01 degrees 00 minutes 28 seconds East a distance of 217.17 feet to an iron rod at the Southwest corner of a private cemetery; thence South 88 degrees 59 minutes 32 seconds East, a distance of 165.00 feet to an iron rod at the Southeast corner of said Cemetery; thence North 01 degrees 00 minutes 28 seconds East, a distance of 264.00 feet to an iron rod at the Northeast corner of said Cemetery; thence North 88 degrees 59 minutes 32 seconds West, a distance of 165.00 feet to an iron rod on the West line of said East Half being the Northwest corner of said Cemetery; thence along said West line, North 01 degrees 00 minutes 28 seconds East, a distance of 1201.05 feet to an iron rod; thence South 86 degrees 27 minutes 30 seconds East, a distance of 2662.09 feet to an iron rod on the East line of the Northwest Quarter of said Section 36; thence South 01 degrees 04 minutes 51 seconds West, a distance of 348.96 feet to a stone marking the Northeast corner of the Southwest Quarter of the Southeast Quarter of said Section 36; thence South 01 degrees 39 minutes 13 seconds West, a distance of 1340.40 feet to the POINT OF BEGINNING, containing 106.0 acres. Subject to that portion currently being used for public roadway.

TRACT 4 DESCRIPTION:
A tract of land lying in the Northeast Quarter of Section 1, Township 46 North, Range 16 West of the fifth principal meridian, Cooper County, Missouri and being more particularly described as follows:
Beginning at the Northeast corner of said Section 1, along the East line of said Section 1, South 00 degrees 13 minutes 54 seconds West, a distance of 1189.44 feet to an iron rod; thence North 90 degrees 00 minutes 00 seconds West, a distance of 936.49 feet to an iron rod; thence South 61 degrees 39 minutes 54 seconds West, a distance of 446.88 feet to an iron rod; thence South 00 degrees 00 minutes 00 seconds West, a distance of 436.83 feet to an iron rod; thence North 90 degrees 00 minutes 00 seconds West, a distance of 674.46 feet to an iron rod; thence North 01 degrees 01 minutes 58 seconds East, a distance of 1966.64 feet to an iron rod on the North line of said Section 1; thence along said North line, South 86 degrees 17 minutes 26 seconds East, a distance of 1977.80 feet to the POINT OF BEGINNING, containing 68.0 acres. Subject to that portion currently being used for public roadway.

TRACT 5 DESCRIPTION:
A tract of land lying in the Northeast Quarter of Section 1, Township 46 North, Range 16 West of the fifth principal meridian, Cooper County, Missouri and being more particularly described as follows:
Commencing at the Northeast corner of said Section 1, along the East line of said Section 1, South 00 degrees 13 minutes 54 seconds West, a distance of 1189.44 feet to an iron rod, said iron rod being the POINT OF BEGINNING; thence continuing South 00 degrees 13 minutes 54 seconds West, a distance of 1444.01 feet to an iron rod at the Southeast corner of said Northeast Quarter; thence along the South line of said Northeast Quarter, North 89 degrees 11 minutes 08 seconds West, a distance of 2012.47 feet to an iron rod; thence North 01 degrees 01 minutes 58 seconds East, a distance of 674.46 feet to an iron rod; thence North 00 degrees 00 minutes 00 seconds East, a distance of 674.46 feet to an iron rod; thence North 00 degrees 00 minutes 00 seconds East, a distance of 436.83 feet to an iron rod; thence North 61 degrees 39 minutes 54 seconds East, a distance of 446.88 feet to an iron rod; thence North 90 degrees 00 minutes 00 seconds East, a distance of 936.49 feet to the POINT OF BEGINNING, containing 54.8 acres. Subject to that portion currently being used for public roadway.

- REFERENCE SURVEYS:**
1. 1978; S.R.BK 1, PG 112;
 2. 1984; MISSOURI LAND SURVEY CO.; PLS #1453
 3. 1992; BK 7, PG 108; CARL DEXTER PLS #189
 4. 2004; BK 8, PG 152; PLS #2009

SURVEYORS STATEMENT
A survey of the property shown hereon has been performed to the best of my knowledge and belief in accordance with the current Missouri Standards for Property Boundary Surveys.

John H. Schaefer,
Missouri P.L.S.#2005000079

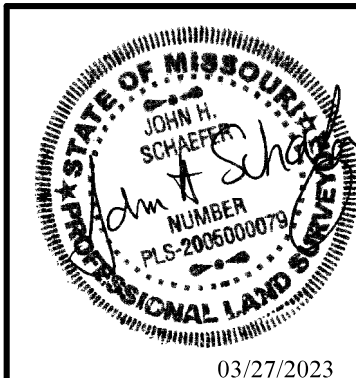

CLIENT: GERALD SHROPSHIRE
DATE OF SURVEY: MARCH 13, 2023
ACCURACY CLASS: RURAL PROPERTY

ALL DISTANCES AND AREAS SHOWN ARE BASED ON GROUND MEASUREMENTS. PROJECT SCALE FACTOR FOR MISSOURI CENTRAL GRID NAD 83 IS 0.99990053.

FIELD: MGW	DRAWN: PEB	PROJECT #23-084
SURVEY CERTIFICATE OF AUTHORITY LS-2009021550		

SCHAEFER
SURVEYING, LLC

John H. Schaefer, PLS
30638 Kenbrook Pl.
Macon, MO 63552

PHONE: 660-395-5942
EMAIL: john@schaefersurveying.com

BOUNDARY SURVEY
PART OF THE SOUTH 1/2 OF SEC. 36,
T47N, R16W, & PART OF THE N 1/2
SEC. 1, T46N, R16W
COOPER COUNTY, MISSOURI