

# Soils Map

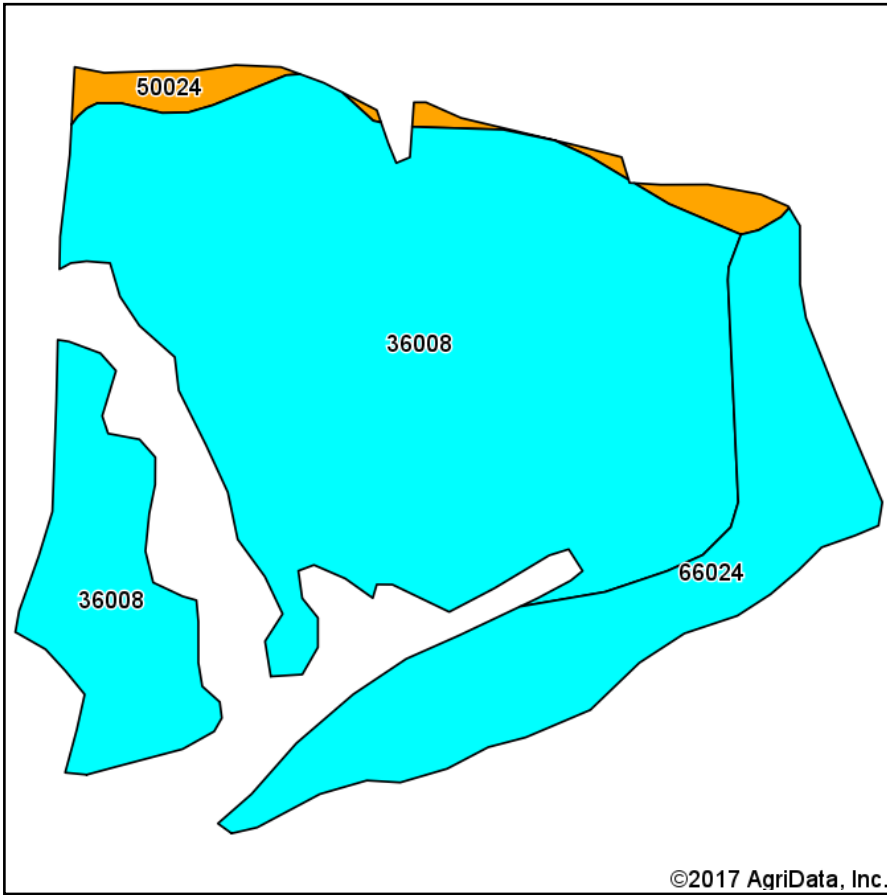

Soils data provided by USDA and NRCS.

©2017 AgriData, Inc.

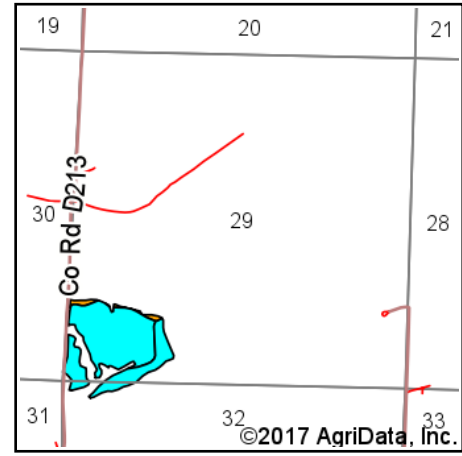

State: **Missouri**  
 County: **Randolph**  
 Location: **29-53N-15W**  
 Township: **Silver Creek**  
 Acres: **37.62**  
 Date: **7/17/2017**



TROPHY  
 PROPERTIES AND AUCTION  
LAND | REAL ESTATE | RESIDENTIAL

Maps Provided By:



© AgriData, Inc. 2017

www.AgriDataInc.com



## Area Symbol: MO175, Soil Area Version: 16

Code	Soil Description	Acres	Percent of field	Non-Irr Class Legend	Non-Irr Class *c	Corn	Soybeans	Wheat
36008	Bremer silt loam, 0 to 2 percent slopes, rarely flooded	28.60	76.0%		IIIw			
66024	Wilbur silt loam, 0 to 2 percent slopes, frequently flooded	7.79	20.7%		IIIw	137	45	53
50024	Gosport silt loam, 14 to 30 percent slopes, eroded	1.23	3.3%		Vle			
<b>Weighted Average</b>						<b>28.4</b>	<b>9.3</b>	<b>11</b>

\*c: Using Capabilities Class Dominant Condition Aggregation Method

Soils data provided by USDA and NRCS.