

**All Measurements are  
For FSA Programs Only**

**Wetland Determination Identifiers**

- Restricted Use
- ▽ Limited Restrictions
- Exempt from Conservation Compliance Provisions

**Ralls Co. FSA**

C=Com Yellow GR, SB=Soybeans COM Gr  
 WHT=Wheat SRW Gr, MILO=SORGH GRS GR  
 DCSB=Soybeans COM Gr DC  
 H=Grass FTA FG I, LS=Grass FTA LS  
 GZ or T31=grass FTA Gz(01) or GZ(31)  
 Alf=Alfalfa FG, O Gr=Oats spr gr  
 CLOVR=Clover Red Fg  
 FP=Wildlife Food Plot  
 \*Unless notated on Map

1:9,890

**Program Year: 2018**

Created: 10/4/2017

Flown: 2016-06-17

clu  
 crp  
 plss

**Farm 1865  
Tract 17252**



# Soils Map

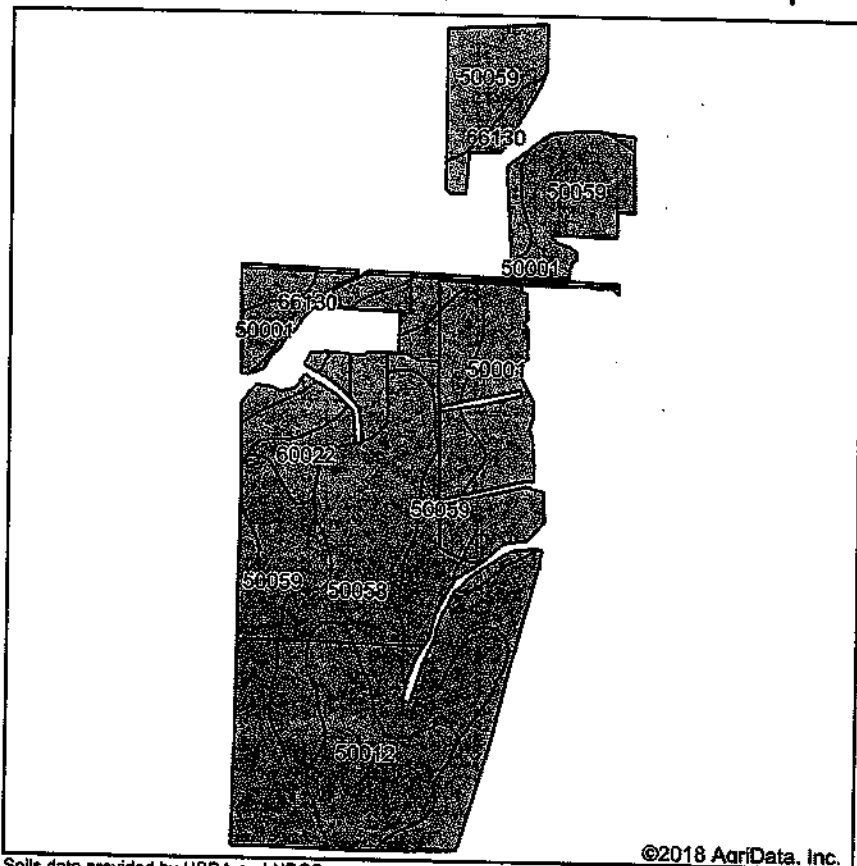

Soils data provided by USDA and NRCS.

©2018 AgriData, Inc.

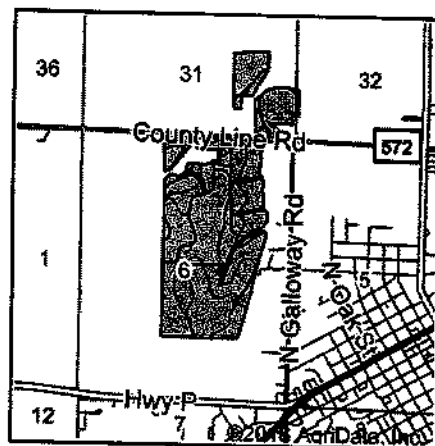

State: **Missouri**  
 County: **Audrain**  
 Location: **6-52N-5W**  
 Township: **Culvre**  
 Acres: **202.98**  
 Date: **3/13/2018**



Maps Provided By:



© AgriData, Inc. 2018 www.AgrIDataInc.com



Area Symbol: MO007, Soil Area Version: 20

Area Symbol: MO173, Soil Area Version: 18

Code	Soil Description	Acres	Percent of field	Non-Irr Class Legend	Non-Irr Class *c	Soybeans	Winter wheat	Corn	Grain sorghum
50059	Mexico silt loam, 1 to 4 percent slopes, eroded	63.53	31.3%		IIIe				
50058	Mexico silt loam, 0 to 2 percent slopes	42.83	21.1%		IIIw				
50001	Armstrong loam, 5 to 9 percent slopes, eroded	30.90	15.2%		IIIe	2	2	5	4
50059	Mexico silt loam, 1 to 4 percent slopes, eroded	24.07	11.9%		IIIe				
50012	Putnam silt loam, 0 to 1 percent slopes	22.39	11.0%		IIIw				
60022	Leonard silt loam, 1 to 6 percent slopes, eroded	7.70	3.8%		IIIe				
66130	Moniteau silt loam, 1 to 3 percent slopes, rarely flooded	5.09	2.5%		IIIw				
66130	Moniteau silt loam, 1 to 3 percent slopes, rarely flooded	4.86	2.4%		IIIw				
50001	Armstrong loam, 5 to 9 percent slopes, eroded	1.61	0.8%		IIIe	2	2	5	4
Weighted Average						0.3	0.3	0.8	0.6

\*c: Using Capabilities Class Dominant Condition Aggregation Method

Soils data provided by USDA and NRCS.