

Quincy Public Schools District #172
Building Data Record

Building Name Washington Elementary School

Address 1401 North 8th Street, Quincy, IL 62301

Grades Housed: Kindergarten - 3rd Gr **Programs:** Special Education

Building Age and Gross Square Footage

Year of Original Building 1922 ① Gross Sq. Ft. of Building as Currently Configured 33,720 sq ft

Building Addition 1953 ②

Building Addition 1969 ③

Construction Timeline

1880	1890	1900	1910	1920	1930	1940	1950	1960	1970	1980	1990	2000	2010
				①			②	③					

Number of Floors 1

Site Size 3.63 ac

Demographics

Enrollment

Grade	2009-10	2010-11	2011-12	2012-13	2013-14
K	68	86	79	75	80
1	62	71	77	75	69
2	75	62	62	82	80
3	66	74	59	65	78
Total	271	293	277	297	307

Free and Reduced Lunch

	2009-10	%	2010-11	%	2011-12	%	2012-13	%	2013-14	%
Free	238	95.2	254	95.17	240	94.57	257	93.56	258	95.65
Reduced	20		22		21		19		28	
Full Pay	13		17		16		21		21	
Total	271		293		277		297		307	

Walk/Ride Eligibility

	2009-10	%	2010-11	%	2011-12	%	2012-13	%	2013-14	%
Walk					190	69%	239	80%		
Ride<1.5 miles					60	22%	53	18%		
Ride>1.5 miles					27	10%	5	2%		
Total	0		0		277		297		0	

Quincy Public Schools District #172
Building Data Record

Building Name Washington Elementary School

Program Spaces

Number of general purpose classrooms: 16

Gross Square Footage of all general purpose classrooms (combined): 11,270

Average Square Footage of general purpose classrooms: 748

Other spaces provided (check all that apply):

<input type="checkbox"/> a. N/A (none)	<input type="checkbox"/> h. Guidance	<input type="checkbox"/> o. Multipurpose Room	<input type="checkbox"/> u. Special Education
<input checked="" type="checkbox"/> b. Administration	<input checked="" type="checkbox"/> i. Gymnasium	<input type="checkbox"/> p. Music	<input type="checkbox"/> v. Swimming Pool
<input type="checkbox"/> c. Art	<input type="checkbox"/> j. Health Suite	<input type="checkbox"/> q. Pre-K	<input type="checkbox"/> w. Teacher Resource
<input type="checkbox"/> d. Audio Visual	<input type="checkbox"/> k. Home & Careers	<input checked="" type="checkbox"/> r. Remedial Rooms	<input type="checkbox"/> x. Technology/Shop
<input type="checkbox"/> e. Auditorium	<input type="checkbox"/> l. Kitchen	<input type="checkbox"/> s. Resource Rooms	<input type="checkbox"/> y. Other (describe)
<input checked="" type="checkbox"/> f. Cafeteria	<input type="checkbox"/> m. Lg. Grp Instruct	<input type="checkbox"/> t. Science Labs	
<input type="checkbox"/> g. Computer Room	<input type="checkbox"/> n. Library		

Large Spaces - Capacity/Square Footage:

	Sq. Footage	Capacity
Gymnasium	<u>2,520</u>	<u>416</u>
Cafeteria	<u>1,728</u>	<u>47 w/tables and chairs, 102 chairs only</u>
Library	<u>3,120</u>	<u>64</u>

Non-instructional spaces used as instructional spaces ☐ Yes ☐ No

If the answer is yes, which types of non-instructional spaces were being used for instructional purposes?
(check all that apply)

<input type="checkbox"/> 1. Cafeteria	<input type="checkbox"/> 4. Library	<input type="checkbox"/> 7. Storage Spaces
<input type="checkbox"/> 2. Gymnasium	<input type="checkbox"/> 5. Lobby	<input type="checkbox"/> 8. Other (please describe)
<input type="checkbox"/> 3. Admin Spaces	<input type="checkbox"/> 6. Stairwell	<input type="checkbox"/>

For how many instructional days during thru school year (July 1 through June 30) was the building closed due to facility failures, system malfunctions, structural problems, etc.? (if none, enter "0") 0

Is the building used for instructional purposes during the summer? ☒ Yes ☐ No

Have there been renovations or construction in the building during the past 12 months? ☐ Yes ☒ No

Quincy Public School District #172
Building Data Record

Building Name Washington Elementary School

Building Systems

Energy Source

☐ Fuel Oil ☒ Gas ☒ Electric ☐ Solar

Air Conditioning

☐ Roof Tops ☐ Window Units ☒ Central ☐ Room Units

Heating

☐ Central ☐ Roof Tops ☐ Room Units ☐ Forced Air

☐ Steam ☒ Hot Water

Type of Construction

☒ Load Bearing Masonry ☐ Steel Frame ☐ Concrete ☐ Wood

☐ Other

Exterior Surfacing

☒ Brick ☐ Stucco ☐ Metal ☐ Wood

☐ Other

Floor Construction

☐ Wood Joist ☐ Steel Joist ☒ Slab on Grade ☐ Structural Slab

☐ Other

Technology

Classrooms

Number of Classrooms	16
Number of Computers	19
Interactive Board, Projection, Doc Camera & Computer setup	14
Classrooms w/o Interactive Board Setup	2
Age of Computers	4-5 years old

Labs

Number of Labs	0
Number of Computers	0
Age of Computers	0

Office/Administration

Number of Computers	12
Age of Computers	4-5 years old

Quincy Public School District #172
Building Data Record

Building Name Washington Elementary School

Major Projects

Completed Since 1996

Roof	Replace shingles	\$ 91,200
Building Overhang	Repair soffit and rafters	\$ 25,000
		\$ 116,200

Pending Projects

Exterior of Building	Tuck pointing in selected areas	\$ 10,000
Throughout Building	Repair/Replace plaster	\$ 10,000
Throughout Building	Install wire glass in corridor transoms and interior doors	\$ 6,000
Cafeteria	Install acoustical wall treatment around the perimeter of cafeteria	\$ 6,300
Kitchen	Install new slip resistant flooring in kitchen to replace wood	\$ 4,500
Boiler Room	Install fire rated door at the Boiler/Room entry/exit	\$ 1,500
Tunnel and Attic Areas	Install existing fire alarm wiring in new rigid conduit	\$ 25,000
Throughout Building	Replace fire alarm control panel with addressable system and associated devices	\$ 30,000
Classrooms	Install new branch circuits with additional receptacles to accommodate the required electrical loads	\$ 70,000
		\$ 163,300

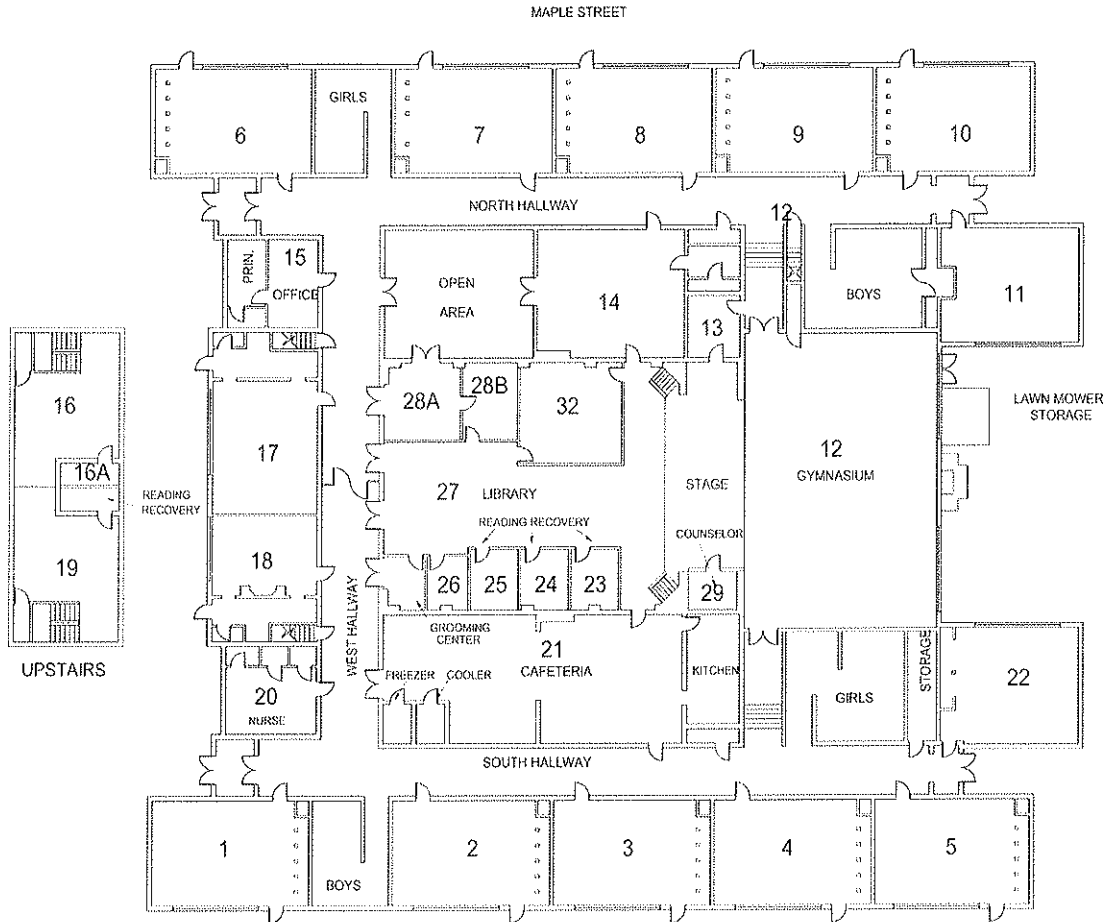

WASHINGTON ELEMENTARY SCHOOL 1400 NORTH 8th STREET

BUILDING SQUARE FOOTAGE 33, 720

QUINCY PUBLIC SCHOOLS DISTRICT 172

QUINCY, IL 62301 REG. MAIL 217-228-4024
FAX 217-228-3129

WASHINGTON SCHOOL FLOOR PLAN

03-09-2012

SCALEABLE



SYCAMORE STREET

