

E Booneslick Rd, Jonesburg, MO 63351, Montgomery County

APN: 15-1.0-12-001-016-010.000 CLIP: 2726220068

	Beds	Full Baths	Half Baths	Sale Price	Sale Date
	N/A	N/A	N/A	N/A	N/A
	Bldg Sq Ft	Lot Sq Ft	Yr Built	Type	
	N/A	12,833	N/A	COM-NEC	

OWNER INFORMATION			
Owner Name	Rose Harold E	Tax Billing City & State	New Florence, MO
Tax Billing Address	Po Box 121	Tax Billing Zip	63363
Tax Billing Address	Po Box 121	Tax Billing Zip+4	0121

COMMUNITY INSIGHTS			
Median Home Value	\$267,171	School District	MONTGOMERY CO. R-II
Median Home Value Rating	4 / 10	Family Friendly Score	59 / 100
Total Crime Risk Score (for the neighborhood, relative to the nation)	71 / 100	Walkable Score	17 / 100
Total Incidents (1 yr)	21	Q1 Home Price Forecast	\$281,373
Standardized Test Rank	32 / 100	Last 2 Yr Home Appreciation	14%

LOCATION INFORMATION			
School District	Montgomery R2	Census Tract	9704.00
Municipality	Jonesburg	Within 250 Feet of Multiple Flood Zone	No
Zip Code	63351	Flood Zone Code	X

TAX INFORMATION			
Tax ID	15-1.0-12-001-016-010.000	Tax Area	JHF
Parcel ID	151012001016010000	Fire Dept Tax Dist	Jhf
Legal Description	12-47-4 FRL PT 19, JONESBURG		

ASSESSMENT & TAX			
Assessment Year	2024	2023	2022
Assessed Value - Total	\$14,750	\$14,750	\$14,240
Market Value - Total	\$46,100	\$46,100	\$44,500
Total Tax	Tax Year	Change (\$)	Change (%)
\$959	2022		
\$993	2023	\$34	3.52%
\$988	2024	-\$5	-0.49%

CHARACTERISTICS			
Lot Acres	0.2946	Land Use - Universal	Commercial (NEC)
Lot Sq Ft	12,833	Land Use - County	Commercial

SELL SCORE			
Value As Of	2025-09-14 04:39:09		

LAST MARKET SALE & SALES HISTORY			
Owner Name	Rose Harold E		

PROPERTY MAP

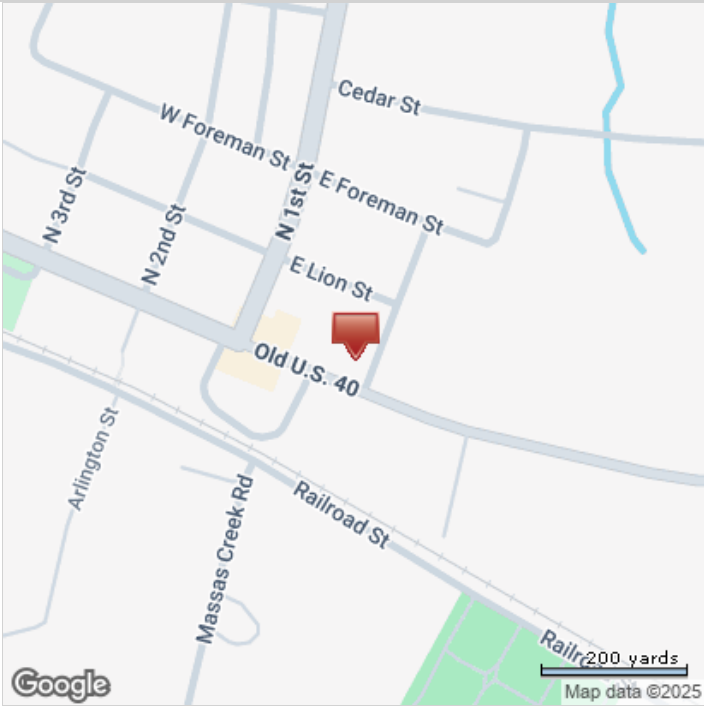
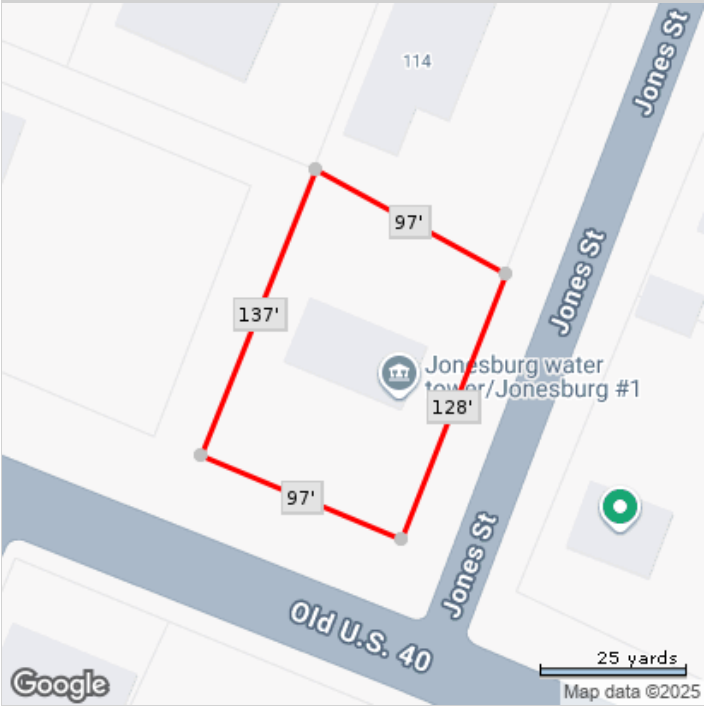

*Lot Dimensions are Estimated